

NIKKEN® PIMAG® ULTRA SHOWER SYSTEM

Advanced Water Filtration and PiMag Technology

Your shower does more than merely get you clean. Every time you take a shower, you absorb water, just as you do when you take a drink. Make your shower a refreshing and healthy part of your daily wellness routine, with the PiMag Ultra Shower System.

This patented, exclusive combination of technologies acts to reduce the level of chemicals and contaminants that may be present in water — including chlorine, which is vaporised in a shower, inhaled, and enters the bloodstream. Copper-zinc granules are employed in a **redox process** (oxidation/reduction electron exchange) to neutralise chlorine in shower water.

Filtration reduces sediment, iron, hydrogen sulfide, heavy metals and organic compounds. **PiMag Water Technology** uses ceramics that produce pi water — the “water of life.” These components include natural minerals found in mountain springs and in deep ocean water.*

Nikken Magnetic Technology helps condition water without salt or other chemical additives.*

*These technologies have not been evaluated by NSF.

You'll notice the difference every time you shower. Softer-feeling hair, smoother skin, and fresher, cleaner water are the results. Enjoy the PiMag Ultra Shower System experience.

INSTALLATION

NOTE: Do not combine this unit with any other filter system (including any other PiMag Shower System). Connect the top fitting directly to plumbing pipe. It may be necessary to visit a bathroom renovation plumbing supplier for an appropriate gooseneck and/or other fittings to complete your installation.

1. Make sure that your shower is completely turned off.
2. Remove any showerhead or showerhead/filter that is currently mounted on your fixture. When removing it, hold the pipe it is attached to firmly, to prevent the pipe from turning inside the wall. Use a wrench or other tool to unscrew it from the pipe.
3. Remove the plastic wrap from the PiMag Ultra Shower System.
4. Line up the screw threads in the inlet of the PiMag Ultra Shower System unit with the threads on the pipe. Turn to tighten, taking care to ensure that the unit is properly aligned.
5. Run the shower and check for leaks. If necessary, remove and reinstall. If unit continues to leak, remove it and wrap Teflon or plumber's tape around the pipe threads. Wrap tape in the same direction as used for tightening threads. Reinstall unit.
6. Run the shower on HOT for at least two minutes, then cool to desired temperature. Repeat this step each time the filter cartridge is replaced.

FILTER REPLACEMENT

Replace the filter cartridge once every six months, or more often depending on condition of water.

1. Grasp the shower unit and with other hand, unscrew and remove the filter dome.
2. Remove the filter cartridge by twisting and pulling. Note that the bottom end of the filter cartridge includes an additional rubber seal (O-ring).
3. Discard the old filter. Insert the new filter in the shower unit, with the bottom end in the correct position.
4. Replace the filter dome and tighten, while firmly grasping the shower unit. Run shower and check for leaks. Repeat assembly procedure if necessary.
5. Run the shower on HOT for at least two minutes before the first use.

For reordering the filter cartridge: Item #13831.

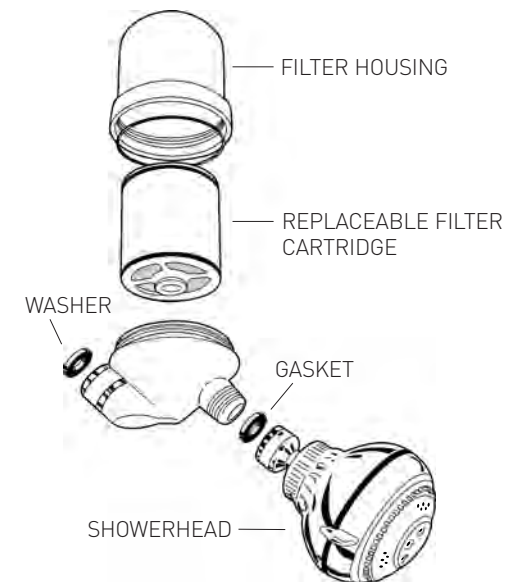

PERFORMANCE DATA:

PiMag Ultra Shower System

Rated service flow	— 9.0 litres per minute
Rated service life at 90% chlorine removal	— 22,700 litres
Maximum working pressure	— 860 kilopascals
Maximum operating temperature	— 49°Celsius

Notes:

- While testing was performed under standard laboratory conditions, actual performance may vary.
- This system is not intended to be used as a drinking water treatment unit.
- Both the system and installation must comply with applicable state and local regulations.



This PiMag Ultra Shower System has been tested according to NSF/ANSI 177 for reduction of free available chlorine. The concentration of free available chlorine in water entering the system was reduced to a concentration less than or equal to the permissible limit for water leaving the system, as specified in NSF/ANSI 177. This system has not been evaluated for free available chlorine reduction performance in the presence of chloramines. Free available chlorine reduction performance may be impacted by the presence of chloramines in the water supply. Please contact your local water utility to determine if chloramines are used in treating your water.

Notes on NSF Test Protocol:

Minimum chlorine reduction per NSF/ANSI 177 shall be listed as $\geq 50\%$ free available chlorine (FAC) when used with an influent challenge water of 2 mg/L FAC.

Average concentrations shall be the arithmetic mean of all reported influent challenge or product water concentrations (the detection limit value shall be used for any nondetectable concentration). The specified average percent reduction shall not be greater than the reduction calculated using the arithmetic means of the influent challenge and the product water concentrations respectively.

90 DAY WARRANTY

The PiMag Ultra Shower System is covered by a 90 day warranty from the date of purchase against faulty materials and workmanship under normal use. This warranty does not cover misuse, negligent handling and/or installation, damage caused by attempted repair. The filter cartridge and replacement filter cartridges are excluded from the warranty.



Nikken Wellness Pty Ltd
11A Columbia Way
Norwest Business Park
Baulkham Hills NSW 2153
Australia
Made in USA

Australia T: 1300 137 366 (02) 8851 5555
New Zealand T: 0800 585 555 (61-2) 8851 5555
www.nikkenwellness.com.au www.nikkenwellness.co.nz

©Copyright 2007 Nikken Wellness

NIKKEN®

PIMAG® ULTRA SHOWER SYSTEM



OPERATING MANUAL

11/07